

## PP FLOW INDICATOR



### TECHNICAL DATA :

**CONSTRUCTION :** 3 piece Design, Full Bore, Borosil Glass, Teflon Seated

**DESIGN AND MANUFACTURING STD. :** As per Manufacturer's Standard

**END CONNECTIONS :** Flanged as per ANSI B 16.5 (150 #) & as per BS 10 (Table D/E/F) & DIN STD.

### AVAILABLE M.O.C. :

PP ( POLYPROPYLENE )

ISOTACTIC PP

PVDF ( POLYVINYLIDENE FLUORIDE )

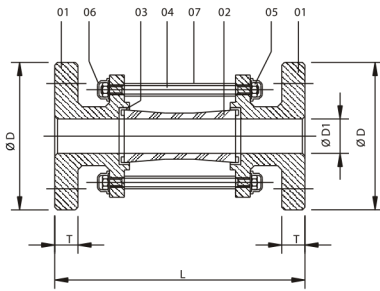

NO.	DESCRIPTION	MATERIAL OPTION	QTY.
01	SIDE PIECE/CONNECTOR	PP / ISOPP / PVDF	2
02	GLASS TUBE	GLASS (BOROSILICATE)	1
03	CRISENT RING	PTFE	2
04	STUD	M.S.(EN8) / S.S.316 PP COATED	REQ.
05	NUT & WASHER	M.S.(EN8) / S.S. 316	REQ.
06	NUT CAP	PP	REQ.

### ALL DIMENSIONS ARE IN MM ( ±2 MM)

SIZE		Ø D	Ø D1	L	T
IN.	MM				
¾ "	20	101.0	19.0	177	14.0
1 "	25	120.0	24.0	191	20.0
1 ½ "	40	138.0	38.0	198	22.0
2 "	50	163.0	50.0	220	24.5
2 ½ "	65	182.0	63.5	255	24.5
3 "	80	200.0	75.0	267	26.0
4 "	100	226.0	100.0	281	28.0
6 "	150	305.0	150.0	403	34.0